

Super Nordstrom Two-Bolt Cover-Type Iron Plug Valves

Short Pattern (Gate Length)

200 CWP (13.8 bar)
400 psig (27.6 bar) Test

Figure 142 Threaded, Wrench
Operated, Sizes ½ to 4

Figure 143 Flanged, Wrench
Operated, Sizes 1 to 5

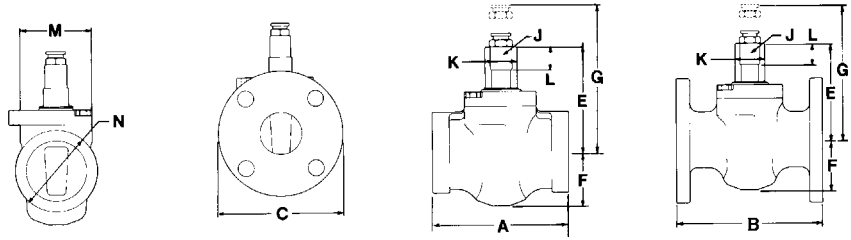

Size	NPS	½	¾	1	1¼	1½	2	2½	3	4	5
	DN	15	20	25	32	40	50	65	80	100	125
End-to-end, threaded, Figure 142	A	4.50 114	4.50 114	4.50 114	5.00 127	5.00 127	5.88 149	7.00 178	7.62 194	9.00 229	
End-to-end, flanged, Figure 143	B			5.50 140	6.50 165	6.50 165	7.00 178	7.50 191	8.00 203	9.00 229	10.00 254
Diameter of flange	C			4.3 109	4.6 117	5.0 127	6.0 152	7.0 178	7.5 191	9.0 229	10.0 254
Center to top of stem	E	3.8 97	3.8 97	3.8 97	4.1 104	4.1 104	4.7 119	4.7 119	5.6 142	6.3 160	6.3 160
Center to bottom of body	F	1.9 48	1.9 48	1.9 48	2.1 53	2.1 53	2.4 61	2.4 61	3.4 86	4.0 102	4.0 102
Clearance required to remove sealant fitting	G	5.5 140	5.5 140	5.5 140	5.8 147	5.8 147	6.4 163	6.4 163	7.2 183	8.0 203	8.0 203
Width of stem flats	J	.81 21	.81 21	.81 21	1.00 25	1.00 25	1.00 25	1.00 25	1.25 32	1.25 32	1.25 32
Diameter of stem	K	1.06 27	1.06 27	1.06 27	1.38 35	1.38 35	1.38 35	1.38 35	1.75 44	1.75 44	1.75 44
Height of stem flats	L	.9 23	.9 23	.9 23	1.0 25	1.0 25	1.0 25	1.0 25	1.3 33	1.3 33	1.3 33
Extreme width of body, Figure 142	M	2.6 66	2.6 66	2.6 66	3.2 81	3.2 81	3.2 81	3.2 81	4.0 102	4.8 122	
Diameter of hub, Figure 142	N	2.3 58	2.3 58	2.3 58	2.9 74	2.9 74	3.6 91	4.3 109	5.2 132	6.4 163	
Size of Sealant Stick	—	B	B	B	B	B	B	B	B	B	B
Size of wrench	—	SN-1	SN-1	SN-1	SN-2	SN-2	SN-2	SN-2	SN-4*	SN-4*	SN-4*
Length of wrench	—	7.0 178	7.0 178	7.0 178	10.5 267	10.5 267	10.5 267	10.5 267	17.5 445	15.0 381	15.0 381
Weight (approx.), Figure 142	—	6 3	6 3	6 3	9 4	9 4	13 6	17 8	29 13	48 22	
Weight (approx.), Figure 143	—			9 4	14 6	14 6	20 9	25 11	38 17	65 29	80 36

Flanges are drilled to ASME Class 125 Cast Iron Flange Standard Template. For drilling and bolting data, see page 45.

Figures 142 and 143 valves conform to the following standards where applicable: ASME B1.20.1; ASME B16.1; ASME B16.10; API 5B; ASTM A126, Class B; and MSS SP-78. See page 38.

Figure 143 face-to-face lengths are interchangeable with ASME Class 125 and API 175 CWP Cast Iron Gate Valves.

Figures 142 and 143 valves Size 5 (125 mm) and smaller are not recommended for temperatures above +200°F (+93°C).

* Use the longer SN-3 wrench for valves used in cold climates such as Canada.

Nordstrom Bolted Gland-Type Iron Plug Valves

Short Pattern (Gate Length)

200 CWP (13.8 bar)
400 psig (27.6 bar) Test

Figure 143 Flanged, Wrench
Operated, Sizes 6, 8 and 10

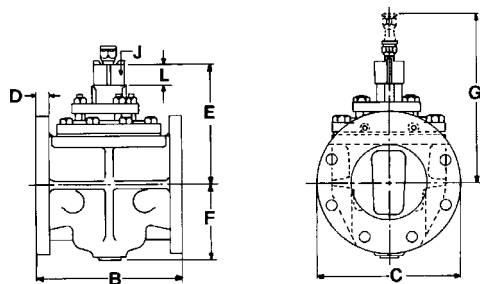

Size	NPS	6	8	10
	DN	150	200	250
Face-to-face, flanged, Figure 143	B	10.50	11.50	13.00
		267	292	330
Diameter of flange	C	11.0	13.5	16.0
		279	343	406
Thickness of flange	D	1.06	1.19	1.25
		27	30	32
Number and size of tapped holes in each flange*	—	two 3/4"	two 3/4"	two 7/8"
Center to top of stem	E	9.6	11.9	14.2
		244	302	361
Center to bottom of body	F	5.4	7.1	9.2
		137	180	234
Clearance required to remove sealant fitting	G	13.6	16.9	19.2
		345	429	488
Width of stem square	J	1.75	2.00	2.00
		44	51	51
Height of stem square	L	1.8	2.0	2.1
		46	51	53
Size of wrench	—	P-2	T-2	T-2
Length of wrench	—	27.0	36.0	36.0
		686	914	914
Size of sealant stick	—	D	G	G
Weight (approx.), Figure 143	—	137	230	356
		62	104	161

Flanges are drilled to ASME Class 125 Cast Iron Flange Standard Template. For drilling and bolting data, see page 45.

Figure 143 valves conform to the following standards where applicable: ASME B16.1; ASME B16.10; ASTM A126, Class B; and MSS SP-78. See page 38.

Figure 143 face-to-face lengths are interchangeable with ASME Class 125 and API 175 CWP Cast Iron Gate Valves.

*Note: Studs or capscrews required. For sizes and lengths, see page 48.